

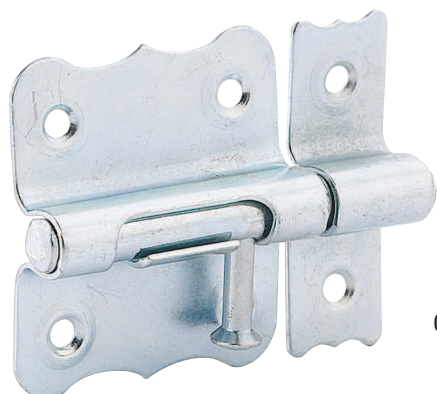

PÊNE ROND

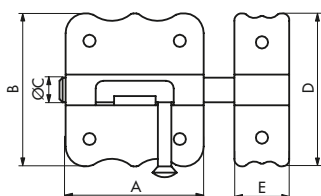

002035



	35 mm	45 mm
A	38	49
B	41	45
C	6	6,5
D	36	36
E	13	13

PÊNE PLAT

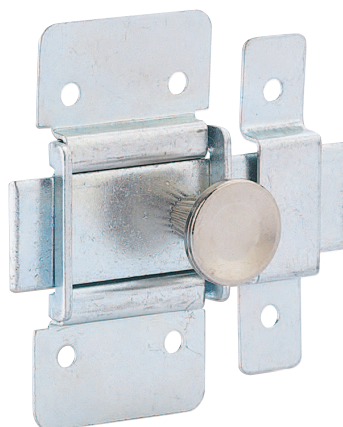

000730

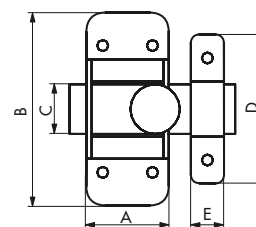

	30 mm	40 mm
A	30	40
B	70	80
C	18	21
D	54	68
E	12	15

Description / Description / Descripción

Platine acier cambré. Gâche acier cambré. Bouton poire. Pêne rond coulissant.

Cambered steel plate. Cambered steel striker. Oval knob. Sliding round bolt.
Pletina de acero curvado. Cerradero de acero curvado. Botón pera. Pestillo redondo deslizante.



Finition / Finish / Acabado

Zingué
Zinc coated
Cincado

Description / Description / Descripción

Platine acier cambré. Gâche acier cambré. Bouton rond nickelé. Pêne plat coulissant.

Cambered steel plate. Cambered steel striker. Nickel plated round bolt Sliding flat bolt.
Pletina de acero curvado. Cerradero de acero curvado. Botón redondo niquelado. Pestillo plano deslizante.



Finition / Finish / Acabado

Zingué
Zinc coated
Cincado

Designation	Boite	Colis.	Bac	Colis.	Blister				Colis.
					France	Euro 1	Euro 2	Euro 3	
TARGETTE zinguée 35 mm	0020359	10	9020350	30	1020358	1930985	1920986	1940984	10
TARGETTE zinguée 45 mm	0020458	10	9020459	30	1020457	1930992	1920993	1940991	10
TARGETTE zinguée pêne plat 30 mm	0007305	10	9007306	30	1007304	1930961	1920962	1940960	10
TARGETTE zinguée pêne plat 40 mm	0007404	10	9007405	10	1007403	1930978	1920979	1940977	10